

Instructions for the Use of the UTA MultiBox® Liber-t France

Settlement of tolls for vehicles up to 3.5 tons and height under 3 metres.

Installation of the UTA MultiBox® Liber-t

- Attach the self-adhesive holder centred at the bottom of the vehicle's windscreen (clean windscreen first, if necessary).
- Push the UTA MultiBox® Liber-t into the holder until it has clicked into place.







Now your UTA MultiBox® Liber-t is ready for use!



Functioning of the UTA MultiBox® Liber-t

- When using your UTA MultiBox® Liber-t, please observe the below mentioned information which is indicated at the toll stations
- After successful booking, the toll gate opens and the traffic light turns green.

Traffic lanes in France

 access and exit	 access and exit	 access and exit
 class 1	 class 2	 class 5
electronic data capture	electronic data capture	electronic data capture
class 1 = passenger cars up to 2 m	class 2 = vans	class 5 = motorcycles

Recommendations to ensure smooth transit conditions:

- Use the corresponding destined lanes at the toll station.
- Slow down when approaching a toll station.
- Keep a minimum distance of 4 metres from the vehicle in front of you.
- Stop immediately, if the toll gate does not open or if the traffic light is red.

What if the toll gate does not open?

- Please stay in your vehicle and do not reverse.
- Use the intercom phone to ask the toll station personnel for assistance.
- To effect a manual toll transaction, please take the UTA MultiBox® Liber-t out of the holder and give it to the toll station personnel for manual data capture: the barcode on the device (reverse side) is scanned and a manual transaction is created.
- If you have received a manual ticket when entering the motorway, you have to choose a toll lane for manual acceptance when leaving the motorway, and present your manual ticket together with your UTA MultiBox® Liber-t. The toll personnel can use your manual ticket and scan the barcode on the reverse side of your Box to create a manual toll transaction.

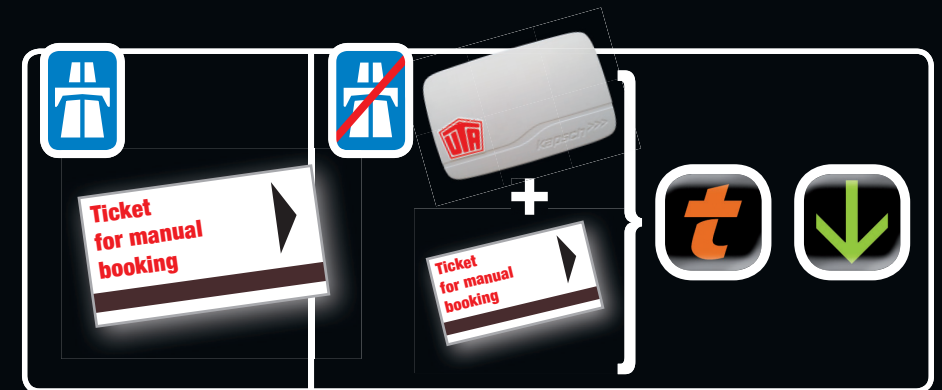

Please ensure that your UTA MultiBox® Liber-t is returned to you.

- In case of assumed or proven malfunction of the UTA MultiBox® Liber-t, please inform UTA immediately.
- Continue to use your UTA MultiBox® Liber-t for settlement of tolls until receipt of your replacement device.
- When returning a device to UTA, please use the coated protective bag destined for dispatch of your UTA MultiBox® Liber-t to avoid unintended toll transactions or any other unintended bookings (due to malfunction etc.).

Have a safe journey!

UTA. Non Stop.

In case of loss, theft or malfunction of your UTA MultiBox® Liber-t, please contact UTA immediately.

For more information:

Phone: +49 (0) 6027 509-617
Internet: www.uta.com

