

UTA MultiBox®Light Manual France/Spain

Fitting of the UTA MultiBox®Light

- Install the self-adhesive fixture in the middle of the windscreen (bottom). Possibly it is necessary to clean the windscreen first.
- Now push the UTA MultiBox®Light into the fixture until the Box has clicked into place.

Your UTA MultiBox®Light is now ready for use!

Functioning of the UTA MultiBox®Light

- When using your UTA MultiBox®Light, please adhere to the below mentioned signage at the toll stations.
- Correct booking results into the opening of the gate and the traffic light turns green.



Motorway lanes in France

Access and exit	Exit	Access and exit:
Class 4 Class 3	Only class 4	Class 4 Class 3
electronic data capture	electronic data capture	manual data capture

Class 3 = trucks with 2 axles

Class 4 = trucks with 3 or more axles

Motorway lanes in Spain

Please use the lanes identified by the following signs:

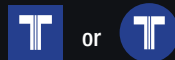

Traffic lanes at Liefkenshoek tunnel

At Liefkenshoek tunnel toll data are captured at a toll station. Lanes 6, 7 and 8 are destined for toll settlement by means of your UTA MultiBox®Light. The relevant lanes are identified by a yellow arrow and are denominated "Abonné".

Recommendations to ensure smooth transit conditions

- Please use the destined lanes at the toll station.
- Slow your vehicle down when approaching a toll station.
- Keep a minimum distance of 4 metres from the vehicle driving in front of you.
- Please stop immediately, if the toll gate does not open or if the traffic light is red.

Please turn over

What if the gate does not open?

- Please stay in your vehicle and DO NOT reverse your vehicle!
- Use the intercom phone to ask the toll station personnel for assistance.
- To effect a manual toll transaction, please take the UTA MultiBox®Light out of the holder and give it to the toll station personnel for manual data capture: the barcode on the back of the device is scanned and a manual transaction is created.
- If you have received a manual ticket when entering the motorway, you have to choose a manual toll lane when leaving the motorway, and present your manual ticket together with your UTA MultiBox®Light. The toll personnel can use your manual ticket and scan the barcode on the back of your Box to create a manual toll transaction.
- If the barcode of the Box is scanned to create a manual transaction, the corresponding rebate can also be granted.
- Please ensure that the UTA MultiBox®Light is returned to you.

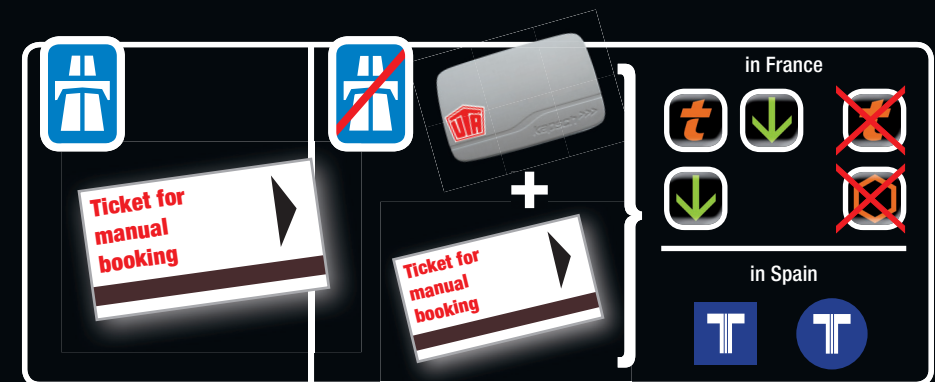

- In case of assumed or proven technical defects of the UTA MultiBox®Light, please inform UTA immediately!
- Please continue to use your UTA MultiBox®Light for settlement of tolls until receipt of your replacement device (rebates are also applicable for manual transactions).
- In order to avoid unintentional transactions resulting from returning a device or from another booking (due to malfunction), please return your UTA MultiBox®Light packed in the purpose-coated protective bag.

UTA. Non Stop.

Have a safe journey!

In case of loss, theft or technical defects of your UTA MultiBox®Light, please advise UTA immediately.

For more details:

Phone: +49 (0) 6027 509-688

